

# From archives to digital tools: the story of research of the EFA at Philippoi, Greece

Catherine Bouras, Laure Franceschi, Bertrand Grandsagne, Louis Mulet, Marie Stahl

catherine.bouras@efa.gr - laure.franceschi@efa.gr - bertrand.grandsagne@efa.gr - louis.mulet@efa.gr - marie.stahl@efa.gr



## Archaeological research at the École française d'Athènes

The École française d'Athènes (EFA) is one of the oldest archaeological institutes in Greece. Its aim has been, since 1846, to study and promote the historical, archaeological and cultural heritage of the country. Through time, the School has long-standing traditions, focuses and sites for the study of which the Library and Archives have collected a great number of records and documents for studies, interpretations, academic works, and...stories.

## The life cycle of research data and the tools available to storymaking

In the era of Digital Humanities, the EFA has developed its own tools in order to manage its data. The planning of an archaeological mission starts on the *Missions* platform, where the information on teams, institutions, sites, finances etc are entered. After the mission is completed, reports are deposited there and at the archives along with photographs. These can be further edited by the excavators on the *Archimage* platforms or once available, visualized and/or downloaded by the public. Short reports serve to compile *Chronique des fouilles en ligne/Archaeology in Greece Online* and longer and more developed reports are made available by the excavators and the publication department on *Bulletin Archéologique des Écoles françaises à l'Étranger* (BAEFE). Eventually the thorough study of the documents are published in one of the journals of the École française d'Athènes or as a monography in one of its Collections. All the data is findable, accessible, interoperable and reusable thanks to the semantic linking of data and metadata of the databases.

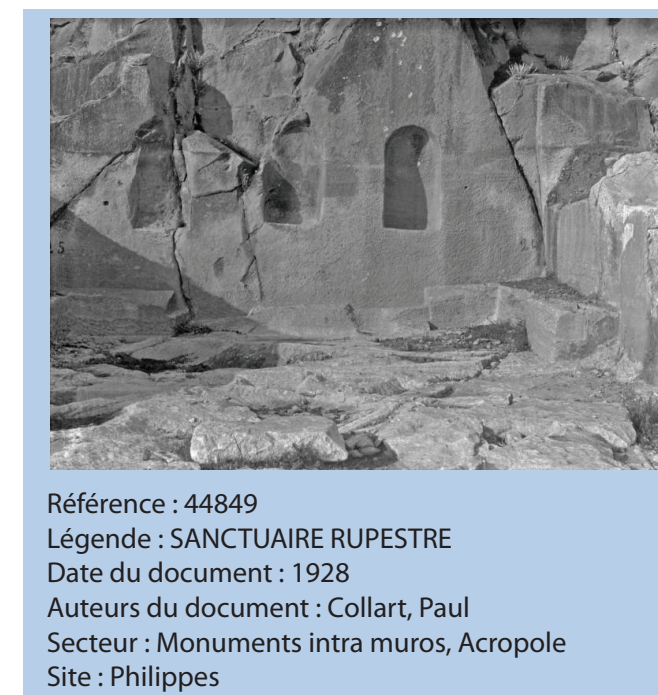

## The research at Philippoi in figures

84 sectors in the forum area  
62 names are tied to research (excavators, architects, photographers, students, etc.)  
12.745 photographs in the archive  
2030 graphic documents (maps, plans)  
182 entries at the archives  
62 Archaeological reports tied to Krenides, Philippoi with 16 photographs from reports or bibliographical references  
1420 published articles since 1877 and 9 published monographies

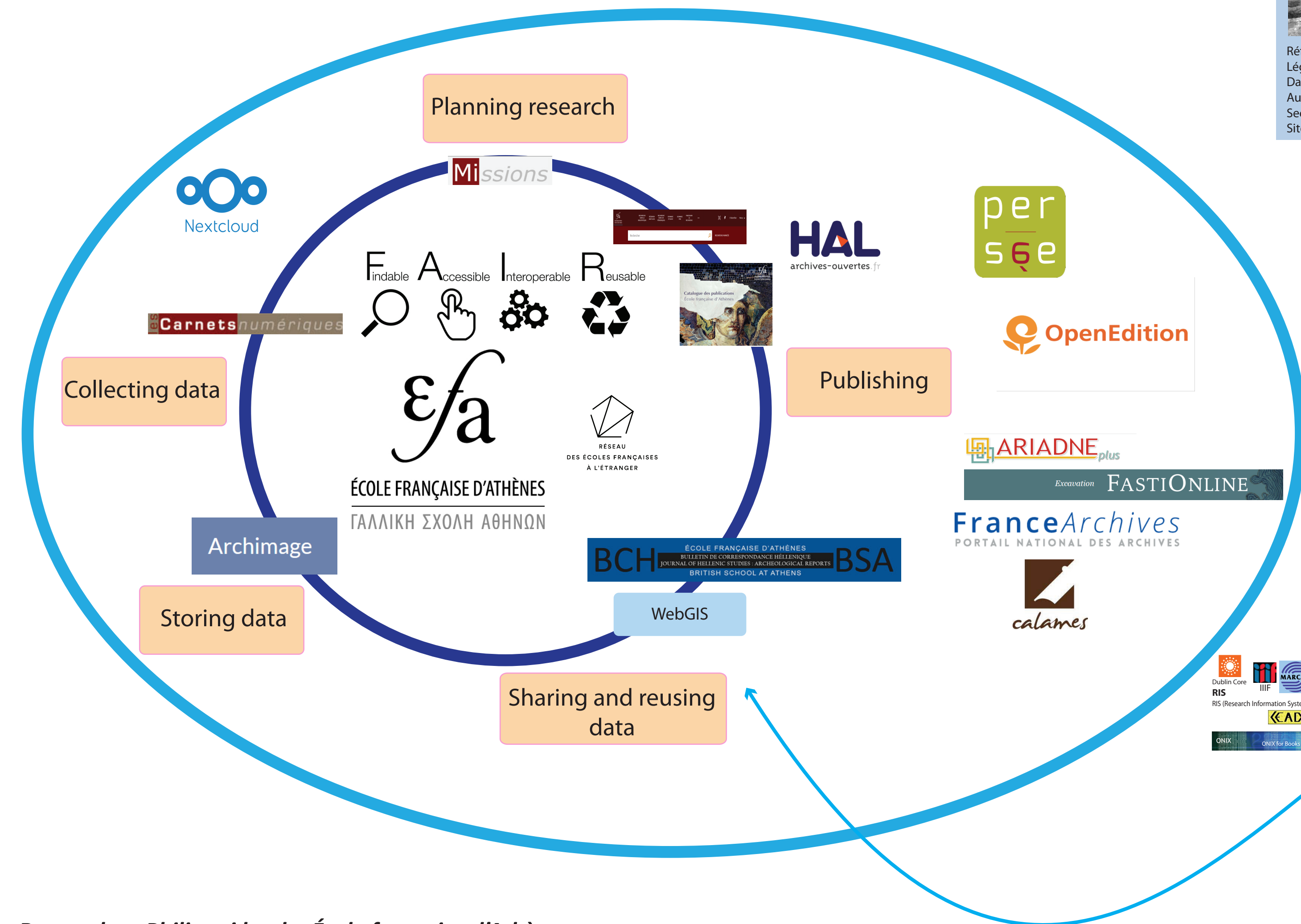
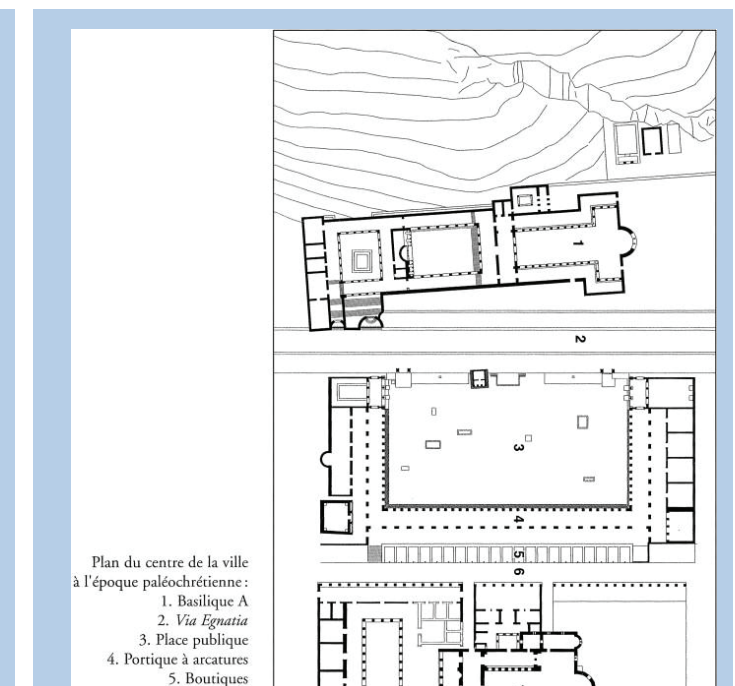
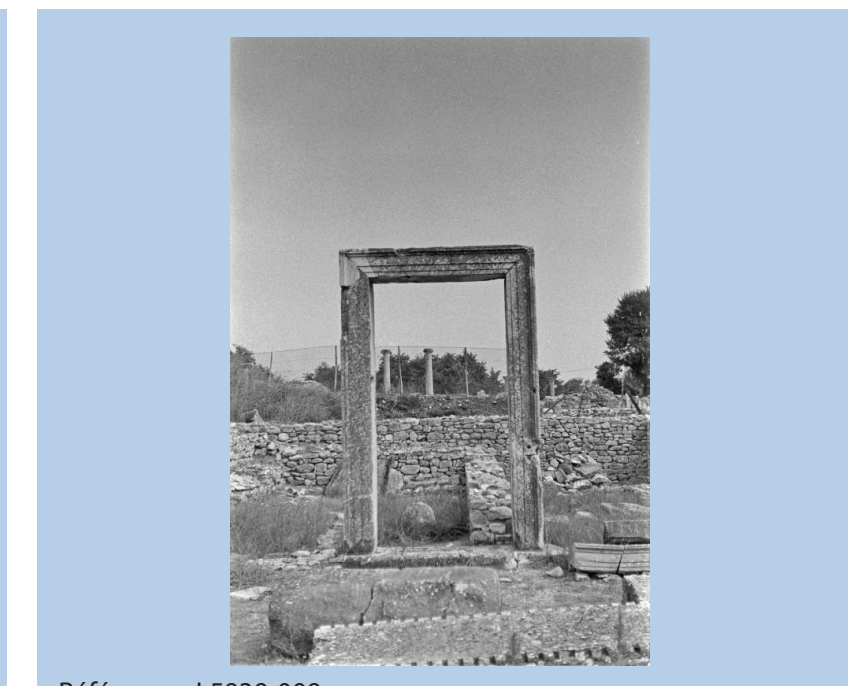
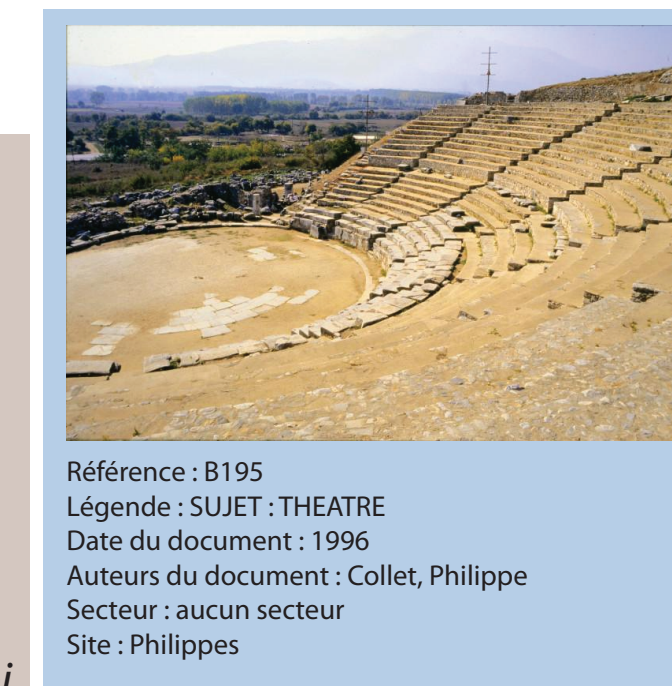

## Research at Philippoi by the École française d'Athènes

The École française d'Athènes has explored the ancient city of Philippoi, in the north of Greece since 1914, when Charles Picard and Charles Avezou, scientific members of the EFA, visited the site and excavated at the rock-cut sanctuaries, the sanctuaries of the acropolis, at the theatre and at the gate of Neapolis. Since, many researchers from the EFA (also from other institutions) have passed through and contributed to the knowledge we have from the site. They left behind an important heritage of written archives, photographic archives, graphic documents (maps, plans, drawings) and ultimately, publications. In the last forty years, the research carried out by the archaeologist Michel Sève (EFA, CRUL) is based on the knowledge acquired by previous researchers. It is also based on his own extensive research on the forum and on the ancient city that he lead in collaboration with others, among who the architect Patrick Weber. Many documents that they have produced are now available online: they all contribute to the architectural study of the forum of Philippoi. This is an example among many others of how the interconnected data available on the EFA's digital tools can contribute to tell the story of research at the forum of Philippoi.

Follow us for more stories : <https://www.efa.gr/fr/>  
@efathenes  
<https://www.efa.gr/fr/newsletter>  
#missiondeterrain  
#actualitedesmembres  
#publicationEFA  
#EFA175 #EFA1821

**Main platforms**

- Missions <https://missions.efa.gr/accueil.php>
- Archimage <https://archimage.efa.gr>
- WebGIS <https://www.efa.gr/fr/sig-a-l-efa>
- Chronique <https://chronique.efa.gr>
- Publications <https://www.efa.gr/fr/publications/presentation-publications>
- Library catalogue <https://www.efa.gr/fr/ressources-documentaires/bibliotheque/accueil-biblio>

