

COLLABORATIVE STRATEGIES



Elif Tinaztepe, Associate Partner, SHL

Marie Østergård, Library Director, Aarhus Public Libraries

Dokk1 – Aarhus' new Main Library and Citizen's Services

Client: Aarhus Municipality

Architects: SHL

Building size: 35.600 m² (383,200 sq.ft.)

Library and Citizens Services: 18.000 m² (193,750 sq.ft.)

Rental spaces: 10.000 m² (107,640 sq.ft.)

Storage, parking, outdoor areas: 7.600 m² (81,805 sq.ft.)

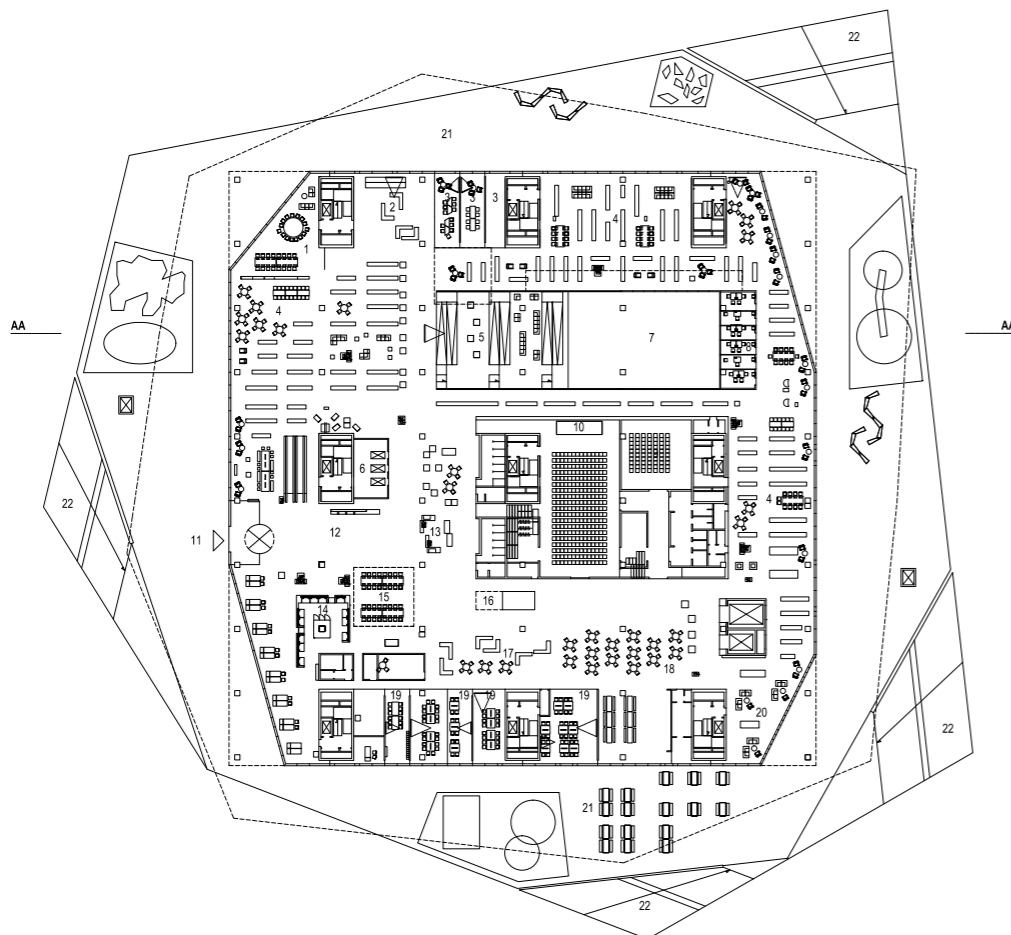



Project from 2005-2015

30.000 m2 (library 18.000)

Opening June 2015

Opening hours

Mon-Fri: 8-22. Unstaffed btw 19-22

Sat-Sun: 10-16

App. 3800 visitors a day (City has 300.000 inhabitants)

App. 5 group tours per week

App. 50 fte library staff – including admin and comm.

1150 seats

325.000 collection items (same as before on 3500 m2)

Space for co-operation

Place for dialogue, knowledge, ideas and inspiration

Open informal learning space

A unique place for children and families



LIBRARY OF THE FUTURE

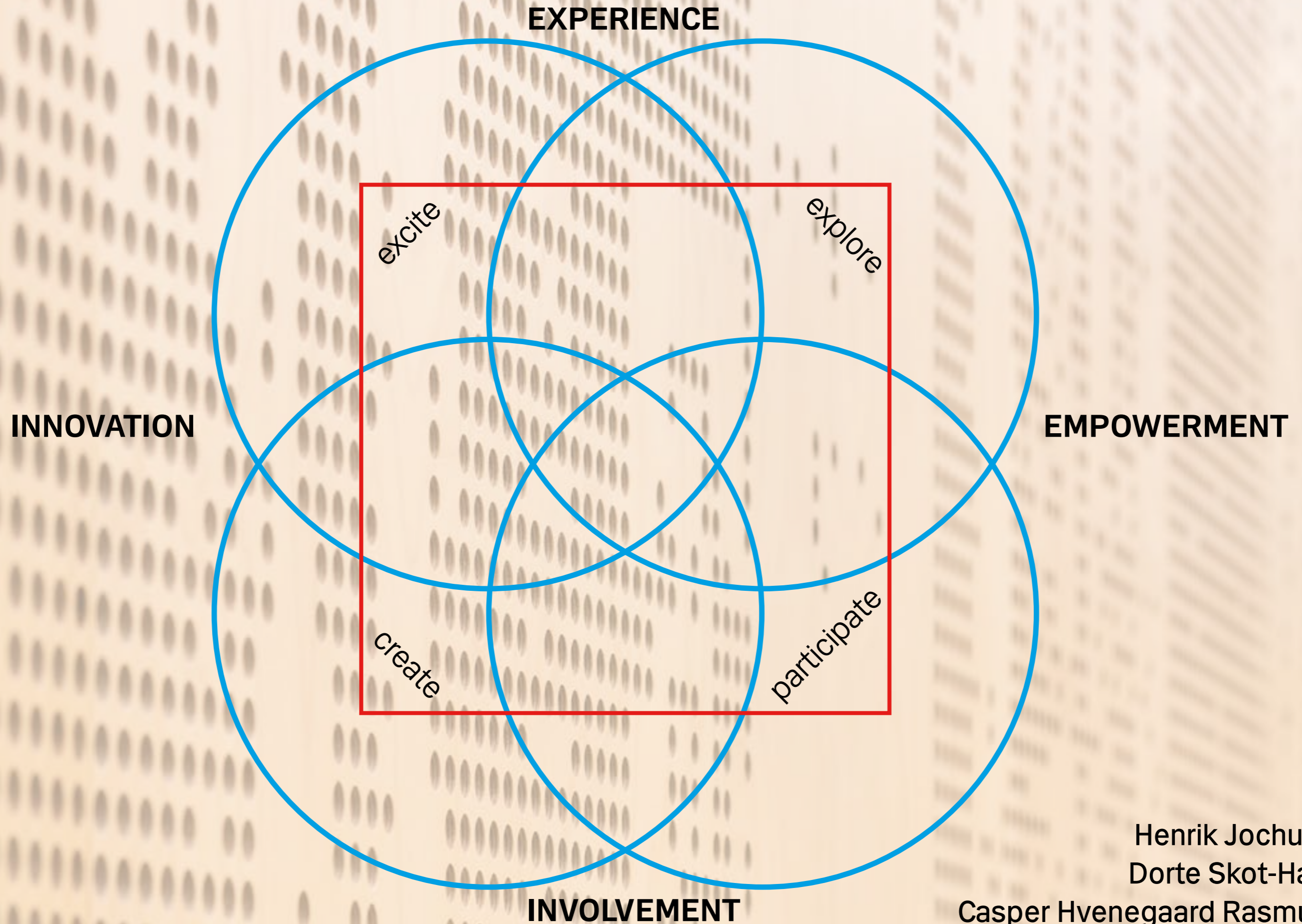

Henrik Jochumsen
Dorte Skot-Hansen
Casper Hvenegaard Rasmussen

The Mash-up Library

Partnerships

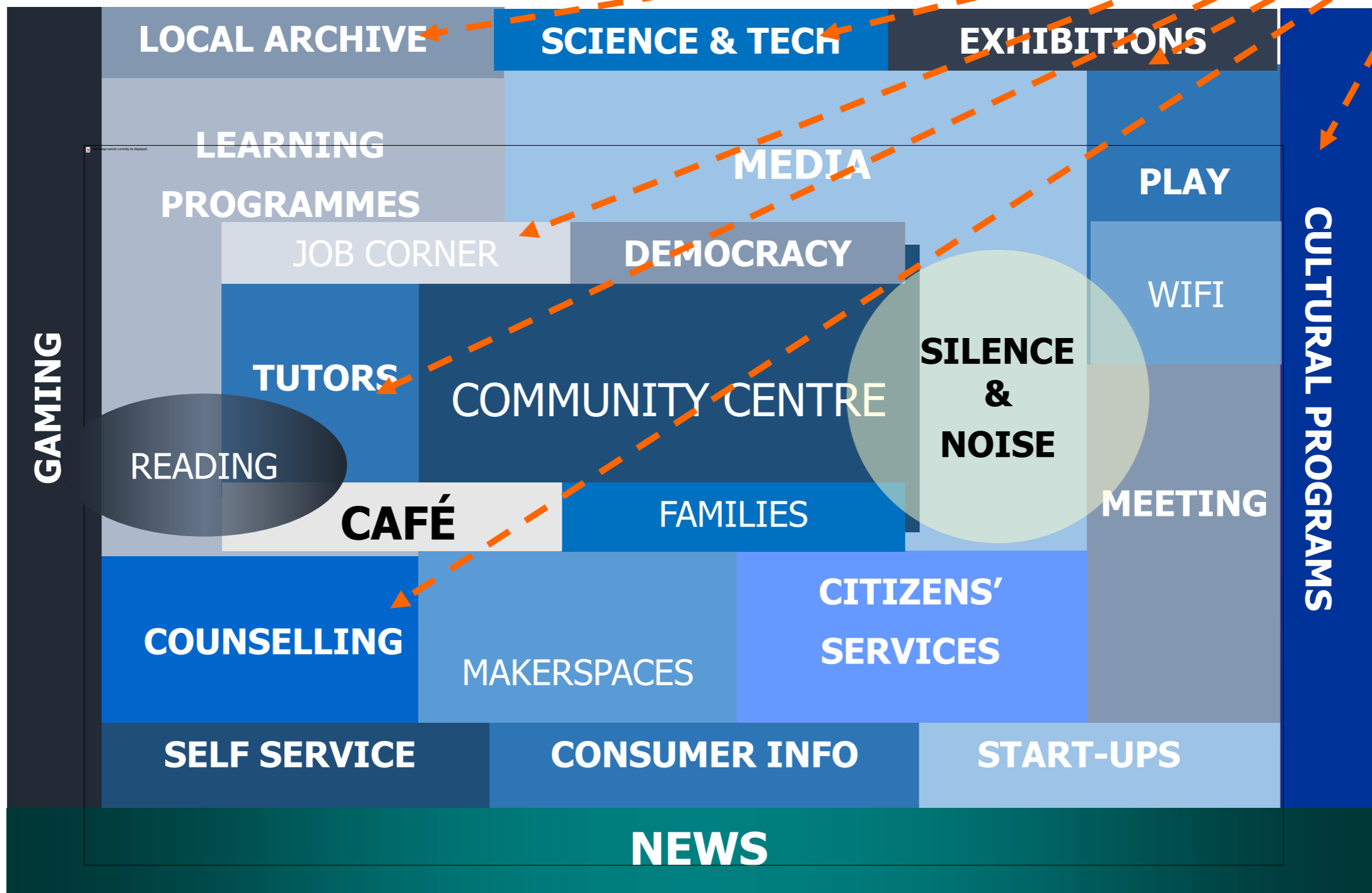

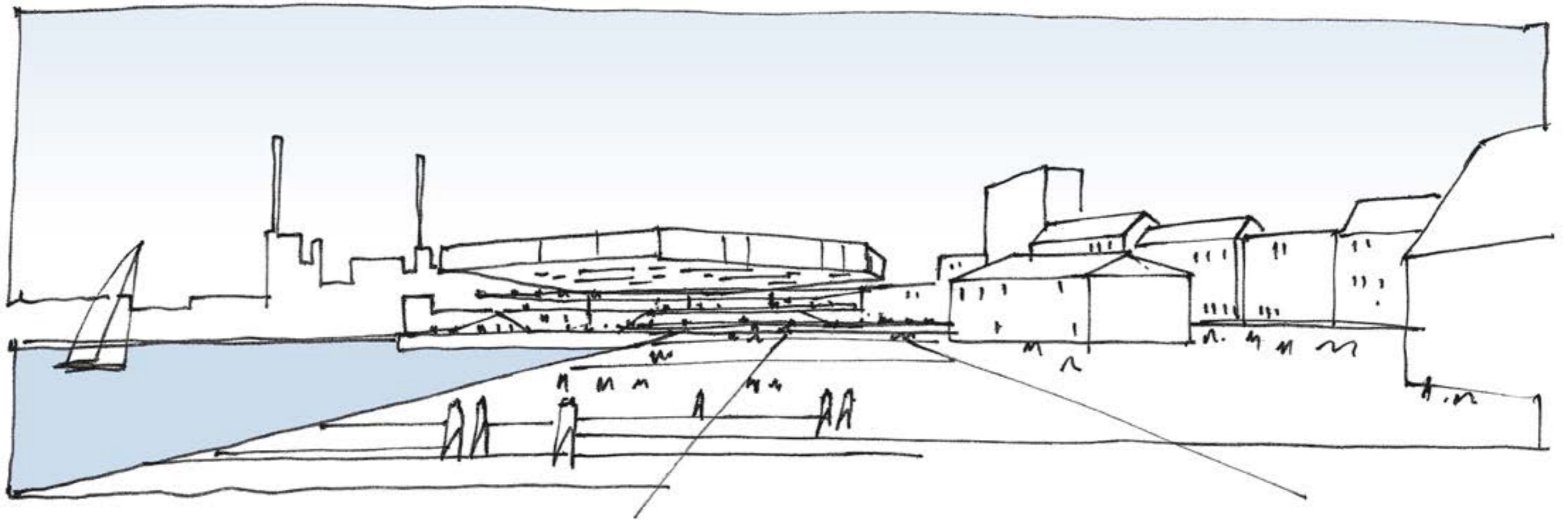

“the library is a covered urban square”

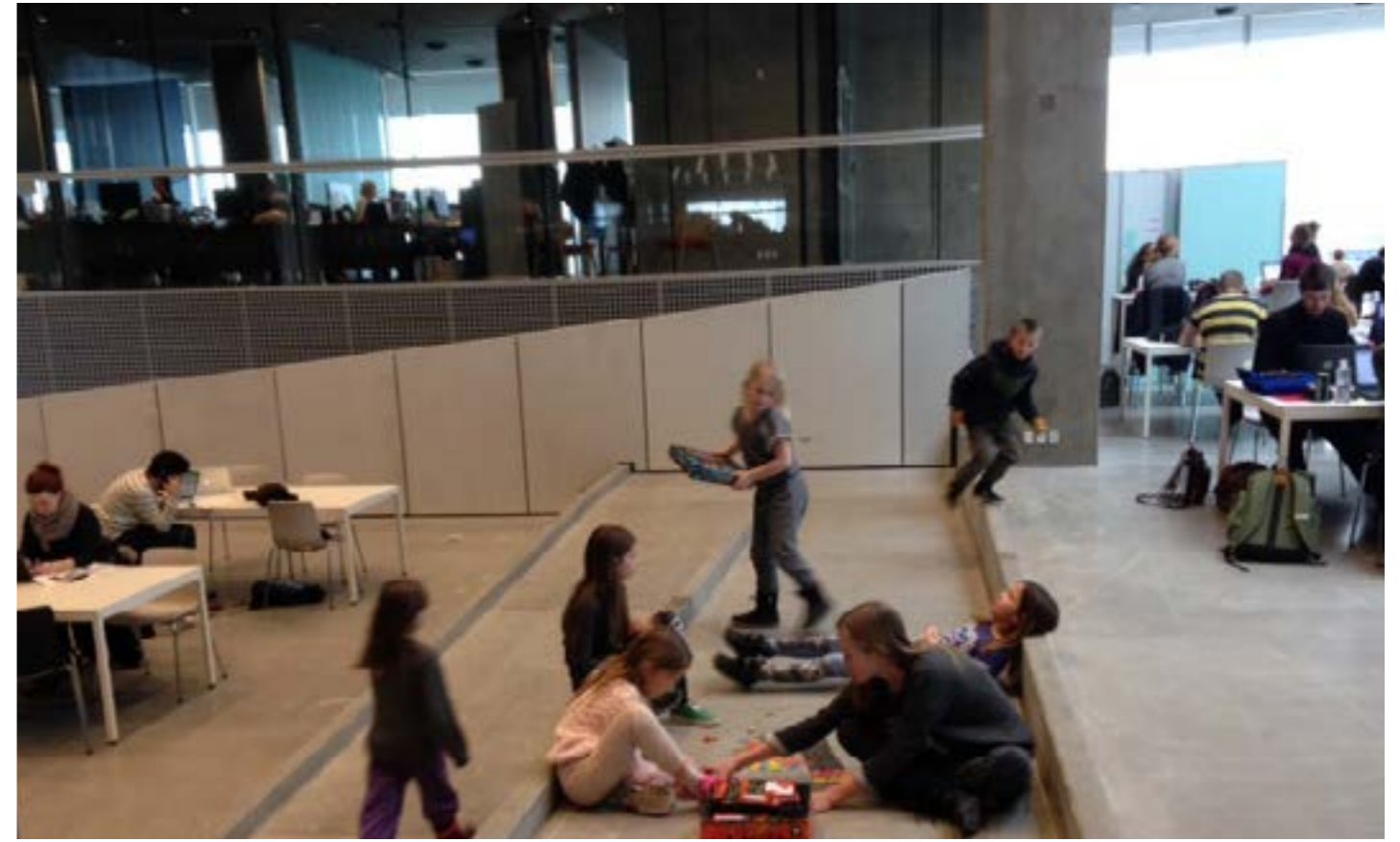









RAMPEN





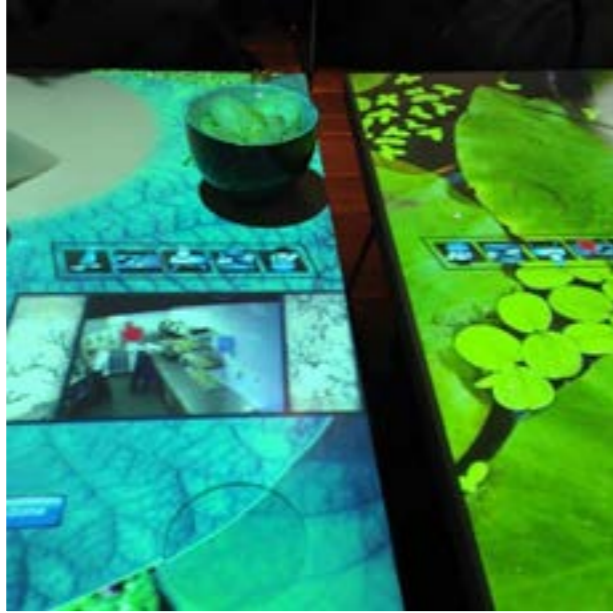

1

Competition
phase A

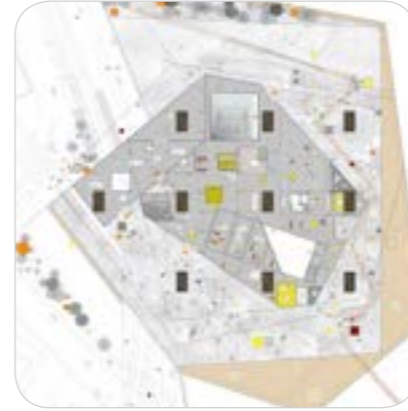

stakeholder
input

2

Competition
phase B



stakeholder/user
input

3

Concept
Design

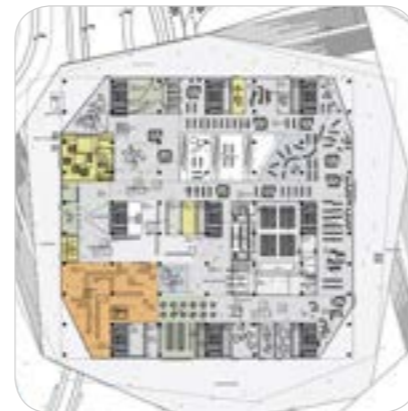

main idea

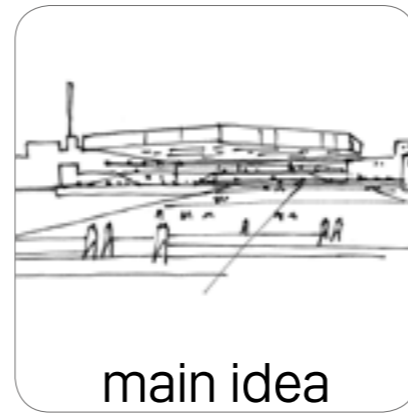

stakeholder/user
input

4
Schematic
Design

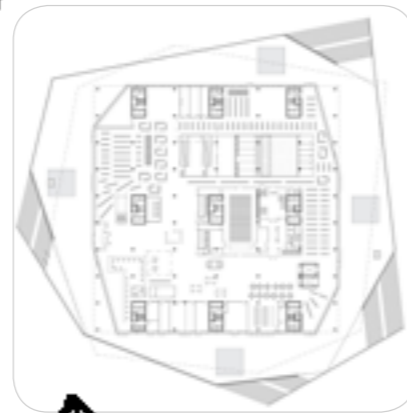



PARTNERSHIPS

strategic, programme-based, network-based

App. 120 programmes each month

- 60 % are carried out by or with partners

- 40 % are done by us



App. 120 registered partnerships

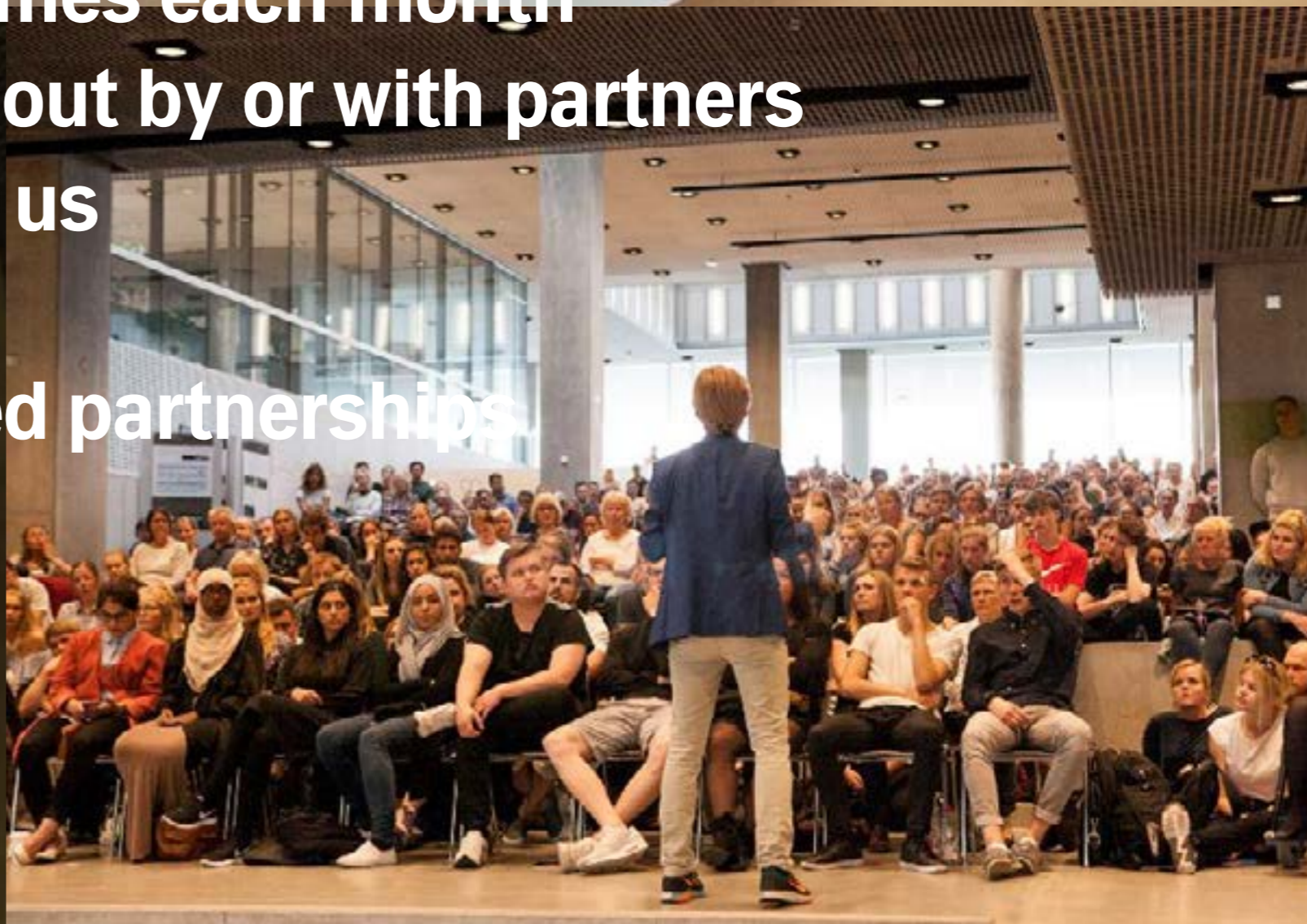



Programmes / house-events

Strong strategy – autonomous staff

Strong focus on legal aspects

Partners challenge everything we thought we knew



**1,5 year to settle and get used to building
and spaces**

**New needs for knowledge chains in
organisation'**

**Higher autonomy – better info channels and
high trust**

**Strong demand for new goals and
strategies**

Design Thinking Skills



User driven spaces

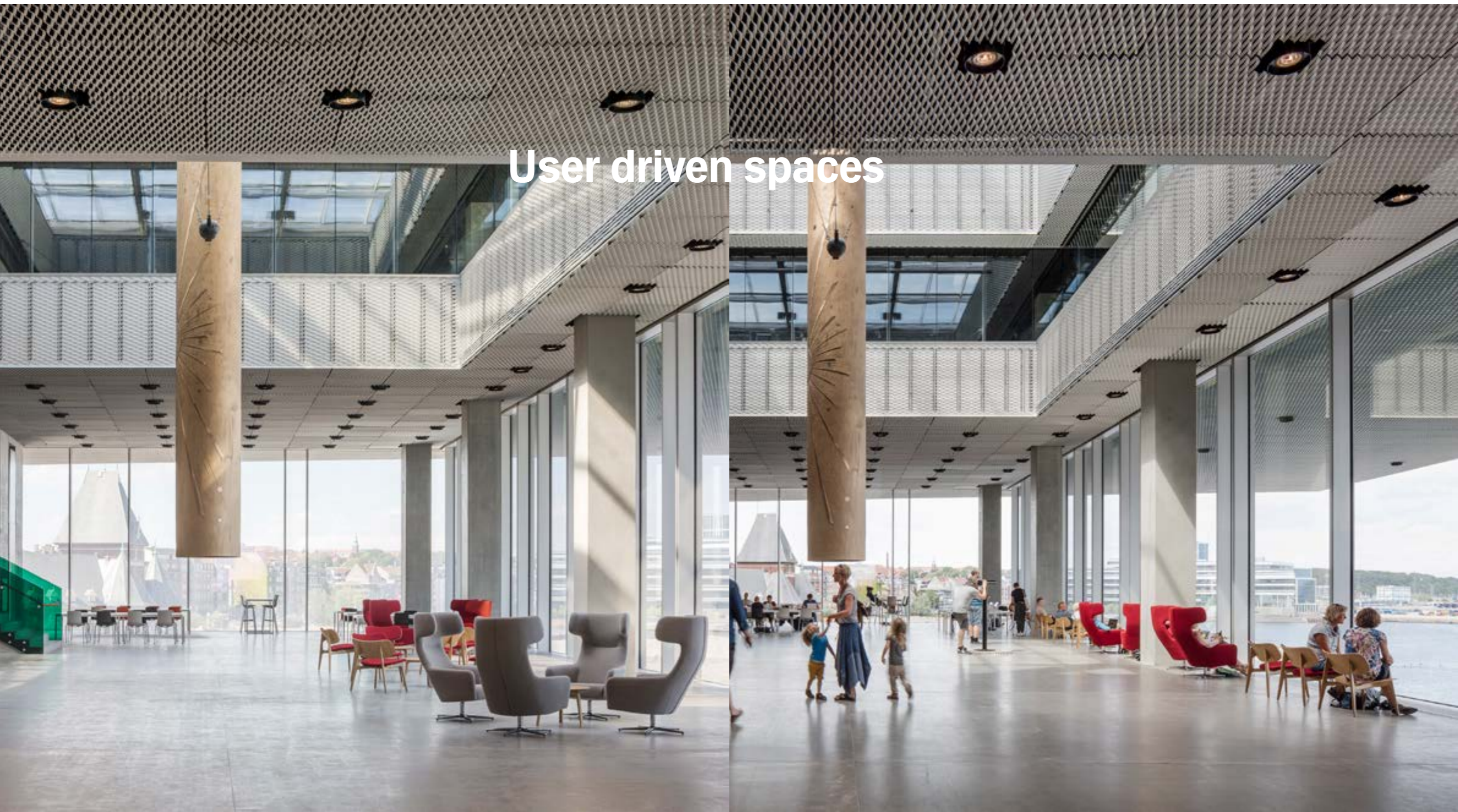



Flexibility and Unprogrammed Spaces



Hovedtegninger/indretning

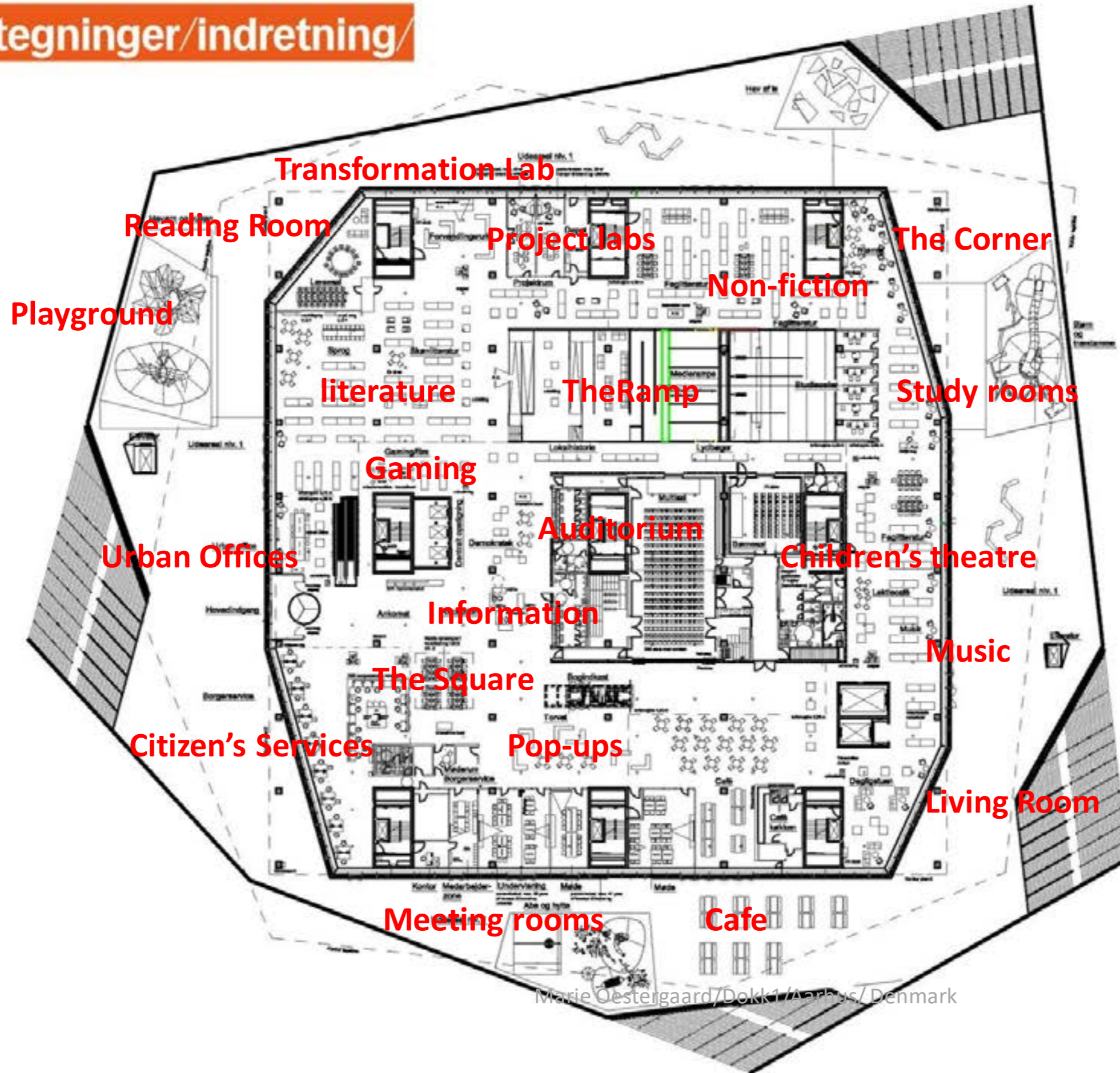

Marie Oestergaard/Dokk1/Aarhus/Denmark

Hovedtegninger/indretning/

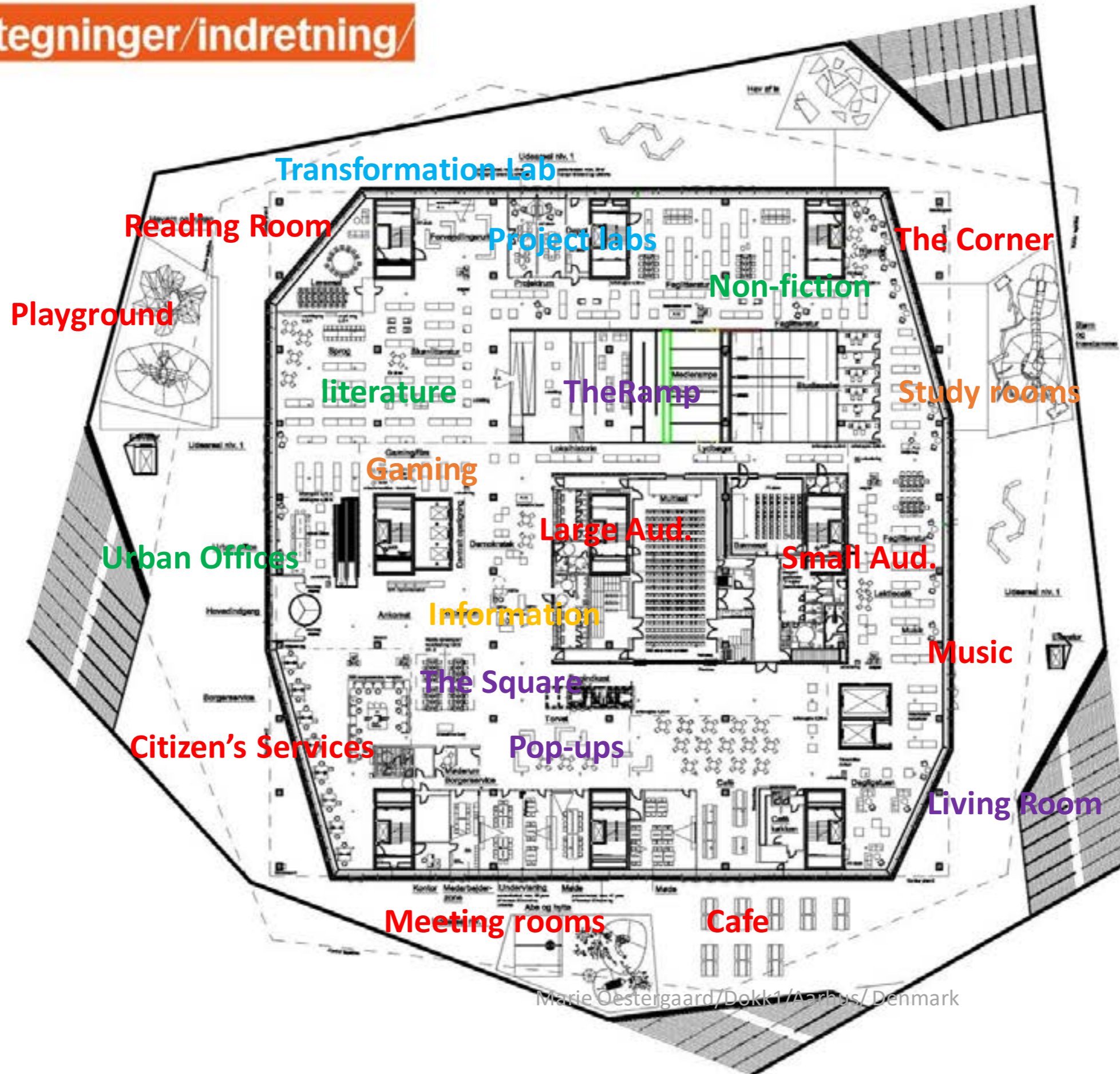

Blue: disappear
 Red: unchanged
 Orange: 1 time
 Green: 2 times
 Purple: stopped counting

Marie Oestergaard/Dokk1/Aarhus/Denmark

Hovedtegninger/indretning/

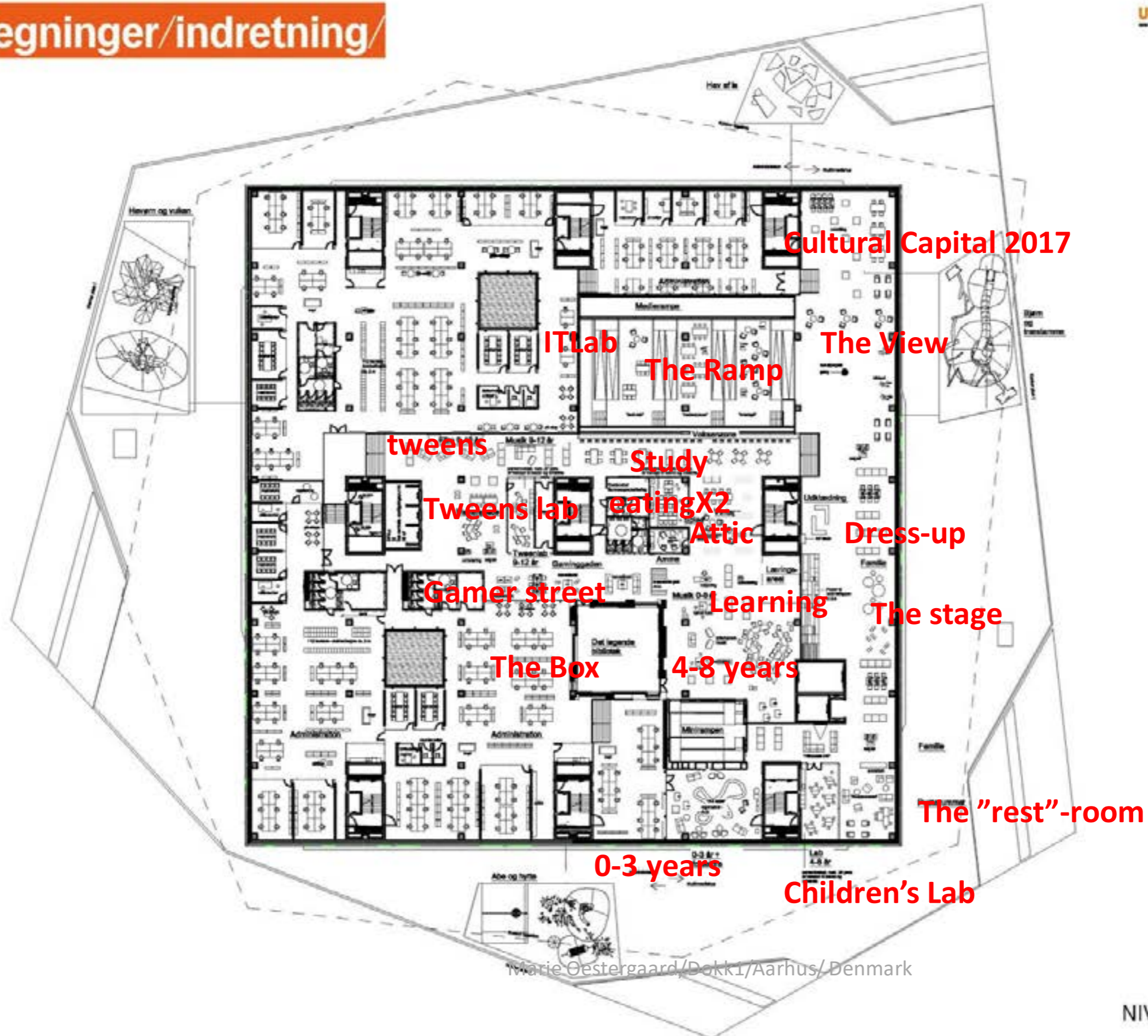

Marie Oestergaard/Dokk1/Aarhus/Denmark

Hovedtegninger/indretning/

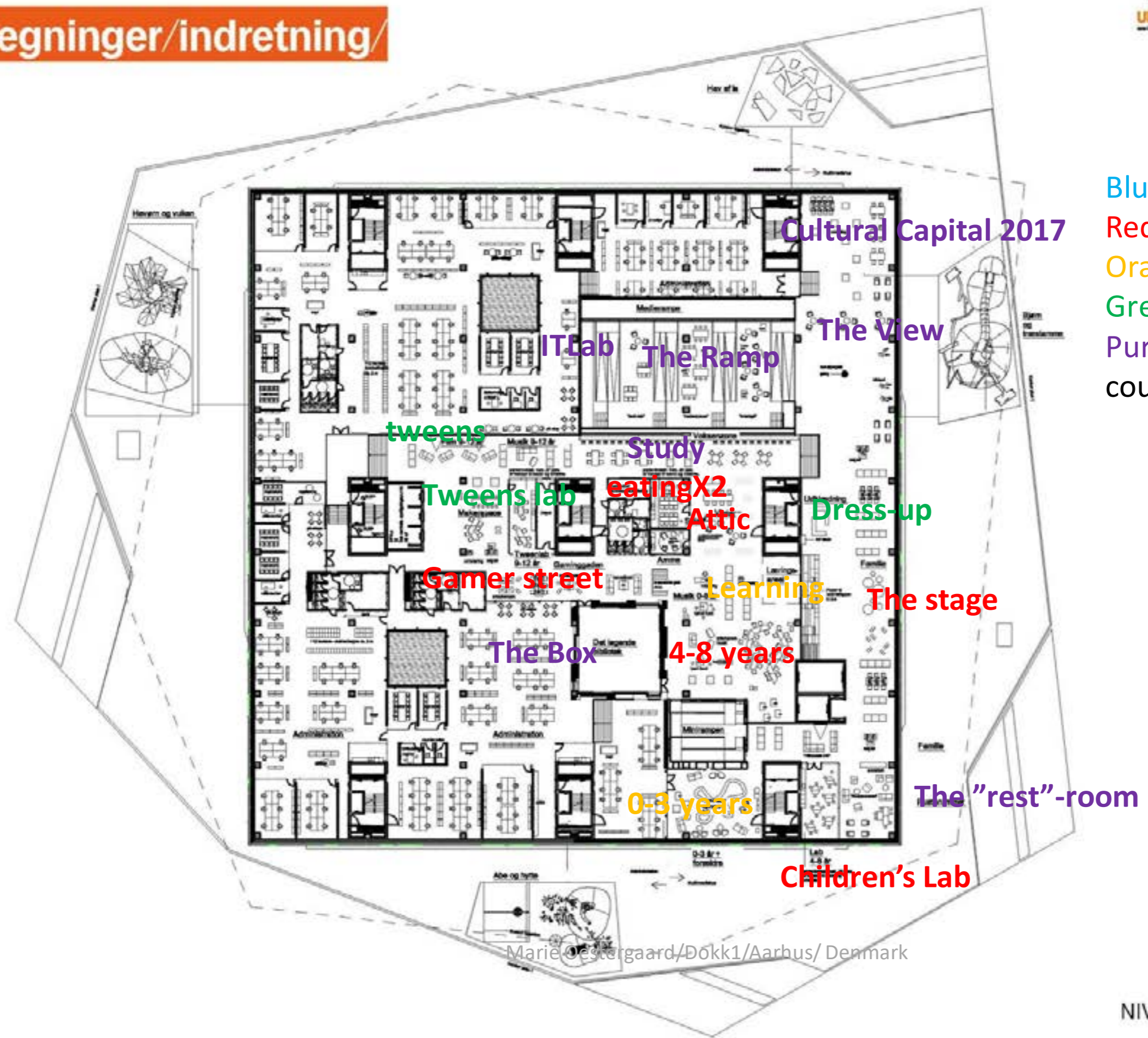

- Blue: disappear
- Red: unchanged
- Orange: 1 time
- Green: 2 times
- Purple: stopped counting

Marie Oestergaard/Dokk1/Aarhus/ Denmark

Flexible vs. Generic

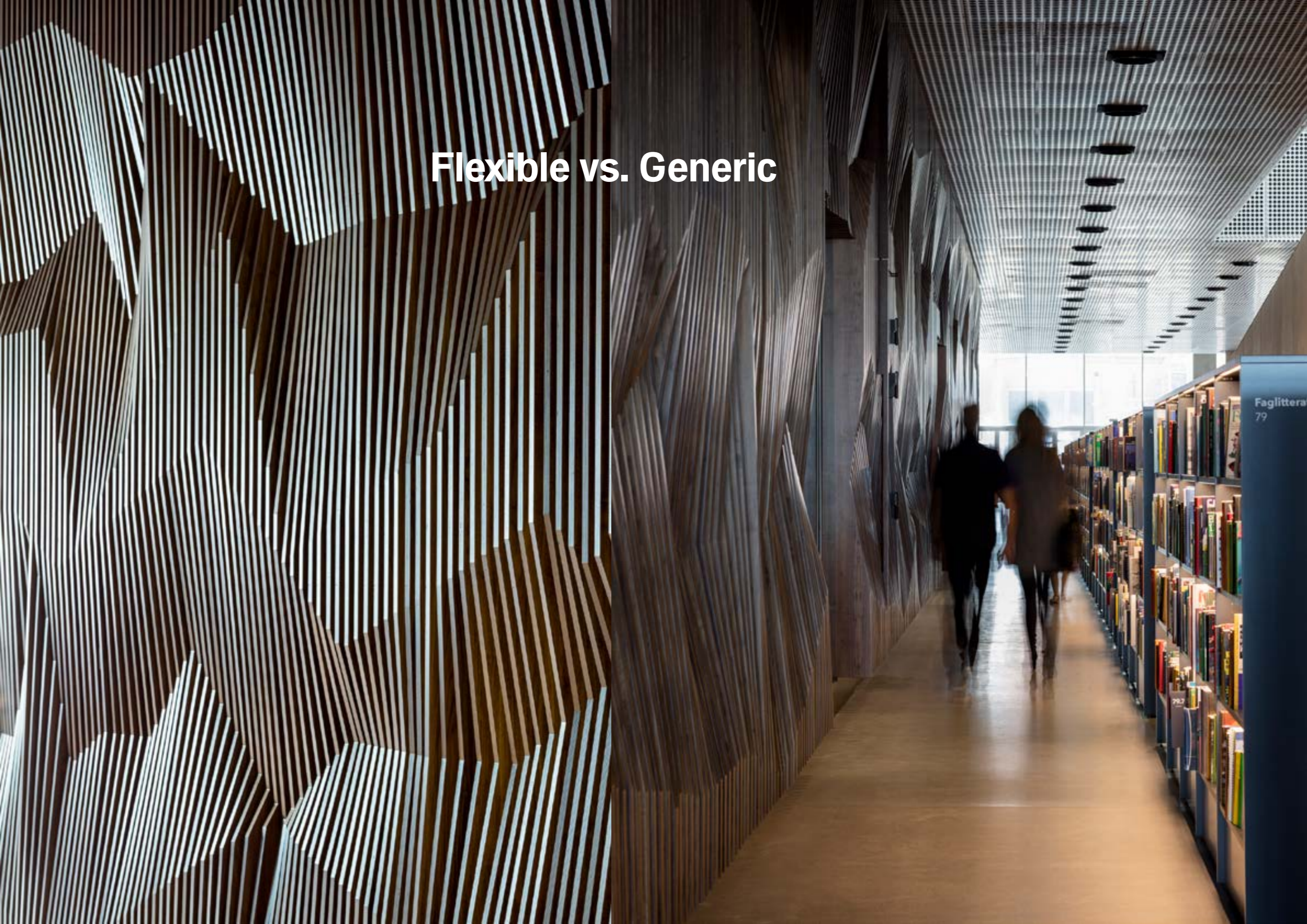



AN ITERATIVE PROCESS

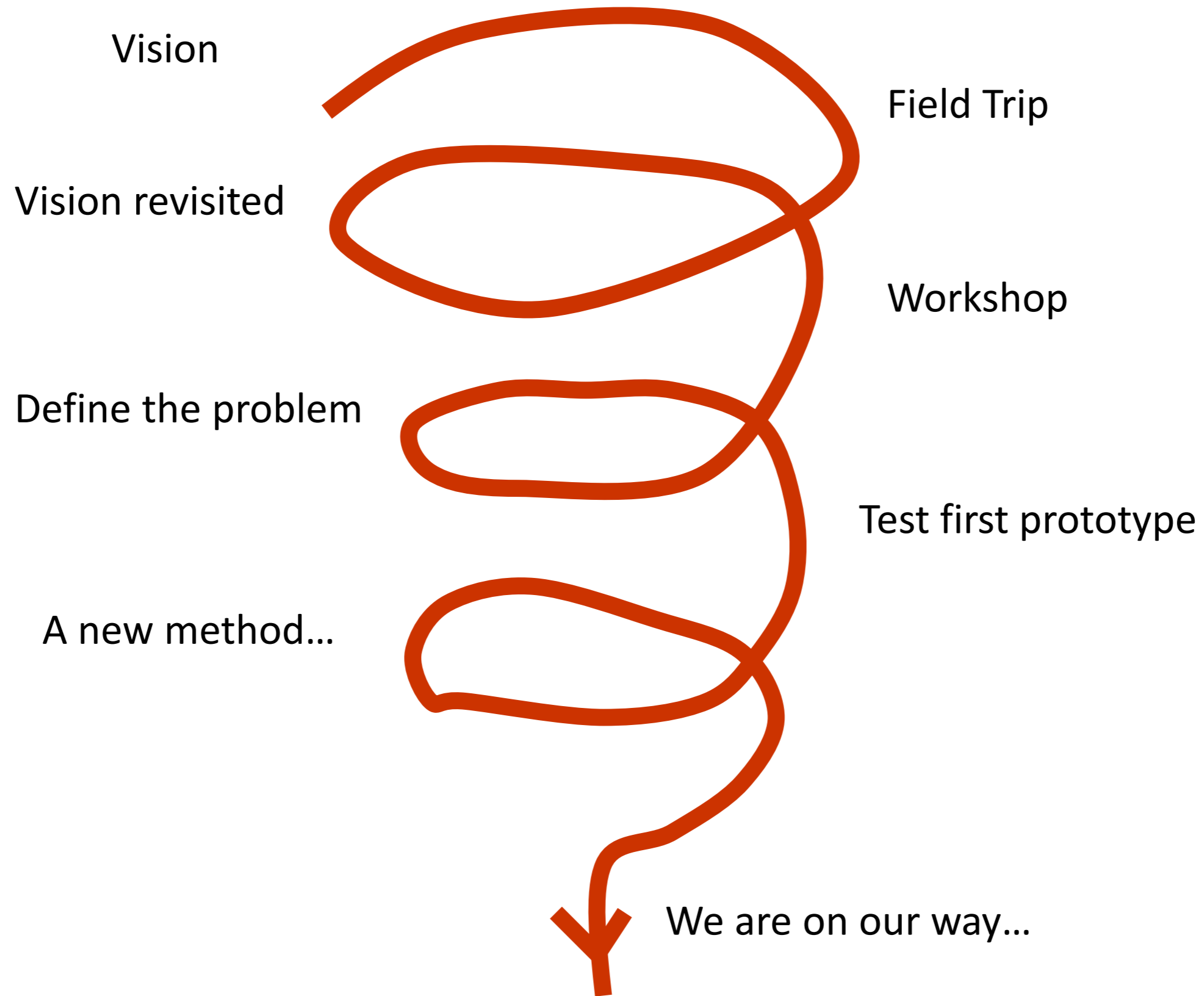



Elif T: eti@shl.dk

Marie Ø: mao@aarhus.dk